



B2KON

"Container Master"



www.b2kon.com

CONTAINER MASTER



Our aim is to offer the needed spaces in the optimum way. We are working hard to produce these areas in the most economical way with high quality, easily installed, re-disassembled after installation, ready-made installations with the highest amount of shipment at once.

"Our responsibilities to the environment, nature and future generations we are aware."

We use energy efficient and recyclable materials in our production.

We offer your facility as packaged at the most affordable prices. With these modules, we enable you to create the facility you want.



For the first time in the world, we can transport 19 piece flat pack containers in 2,4x6 m dimensions by hightway and 15 piece by sea at one time thus we provide high fuel savings and efficiency. We contribute to maintaining the balance of nature with low CO2 emissions.

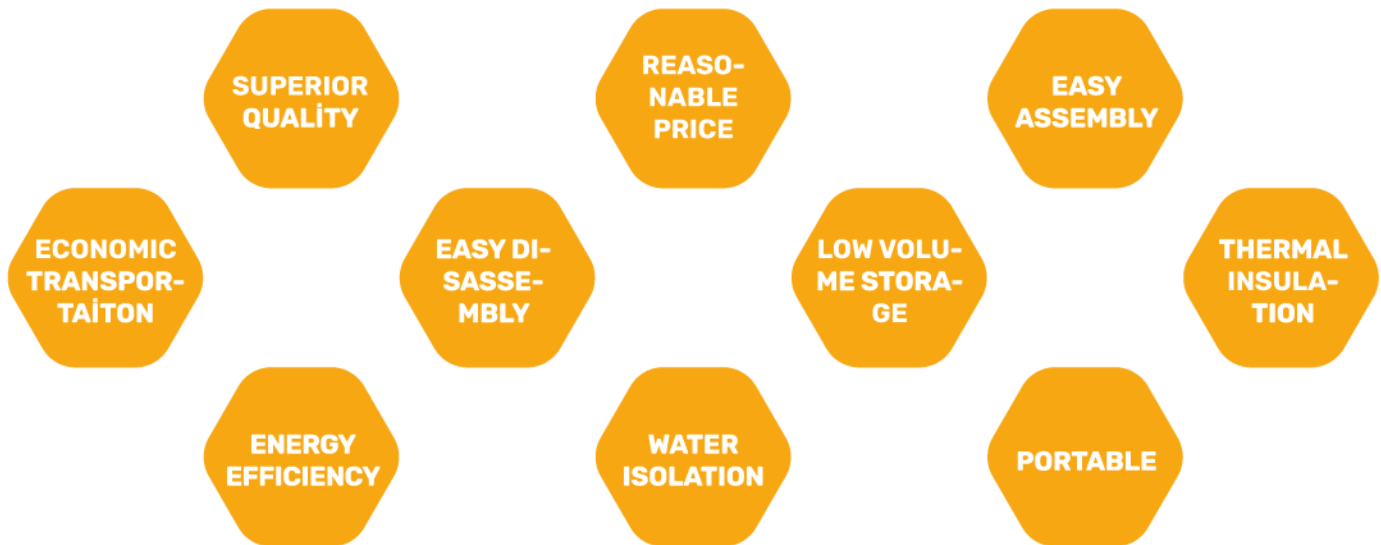

 **B2KON**

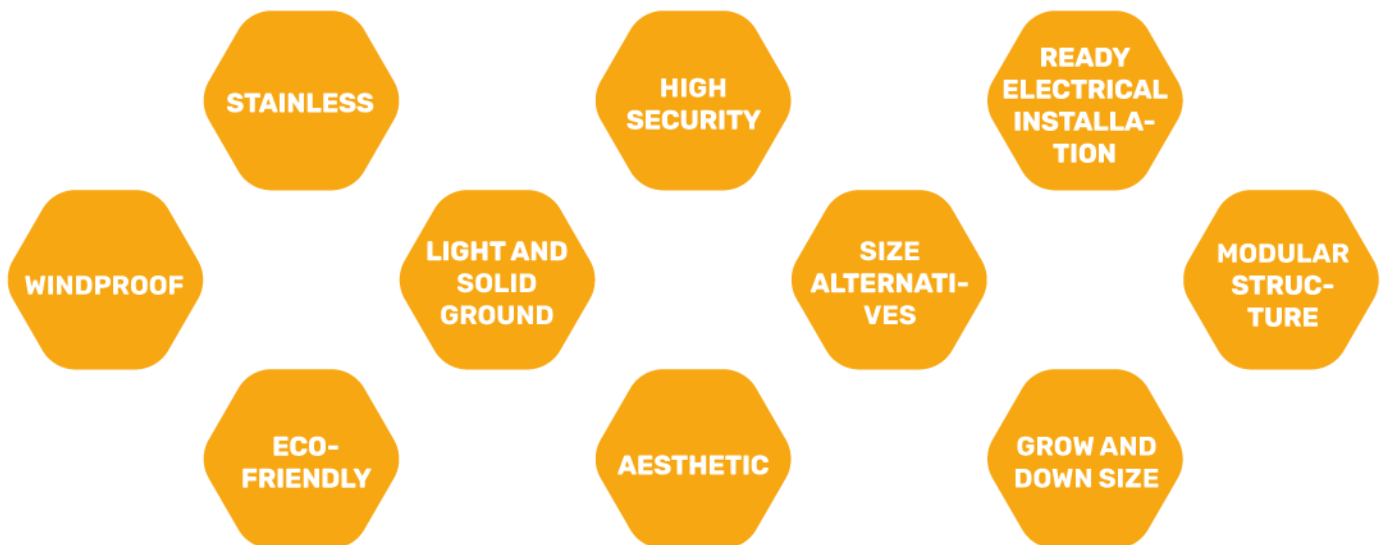

*We reduce the need for new products as much as possible by simplifying assembly and disassembly and ensuring long-lasting use.
We prioritize energy efficiency with the choice of recyclable, low energy consumption materials and nature-friendly production center.*





TRIMOD

Triple Module Container

238cm x 600cm x 250cm



- 14.4 m² formed by the addition of three unit modules get your space in a short time
- Waterproof walls heat and windproof insulated roof.
- Unlimited assembly and disassembly
- Compact and multipurpose
- Ideal for construction site, technical office, storage, office, sales station, home etc.
- Possibility to convert to Unimod and Duomod later.



WIDE



BOX



LUMI



WIDE *Trimod*

It is the container with two windows and one door in the long direction. It is one step ahead with its ability to respond to all space needs and design flexibility.

BOX *Trimod*

It is the container that contains a window and a door in the short direction. Your assistant in creating productive areas with its superior insulation properties.

LUMI *Trimod*

It contains three spacious walls in the long direction and a door and window in the short direction. Using light effectively and inside the container It allows you to showcase.



WIDE



BOX



LUMI



High Insulation
Full Waterproof



High Security



Ready Electrical System All
in One Point Full
Protection



LED Technology
Recessed Luminaire



Easy Installation
Lightweight and Robust



Aesthetic Combinations
Useful Areas

CHASSIS



CAPACITY	RUST PROTECTION	PAINT	SNOW LOAD
*200kg/m ²	DKP Sheet	Filler+Top Coat Paint	80kg/m ²
300kg/m ²	*Zinc Coated Sheet (Galvanised)	-	*100/m ²
400kg/m ²	-	Powder Coating	-

UPPER MODULE

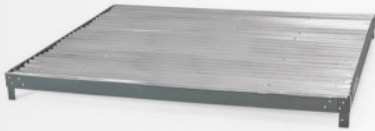

ELECTRICITY	INSULATION	CEILING COATING MATERIAL
Without Electrical Installation	*Mineral Wool	*PVC Wainscot
*Leakage Current Protection Installation	-	Wood Paneling

SUB MODULE



COATING MATERIAL	INSULATION	PATTERN
*PVC Floor	*Felt	* Hardwood Look
SPC Flooring	Additional Foam Insulation	Mercenary View
Aluminum Floor Coating	-	Industrial Look

WALLS



INSULATION	THICKNESS	PATTERN
EPS* Expanded Polystyrene	4*	*Deep Trace
PUR Polyurethane	5	Micro Pattern
PIR Polyisocyanurate	8	Sine Wave
Rock wool	10	Siding Pattern

* The specified features are those found in the standard product. You must specify other options before ordering.

WALL MODULES



Wall with Door



Lumi Wall



Wall with Single
Opening Window



Double Window Wall



Blank Wall

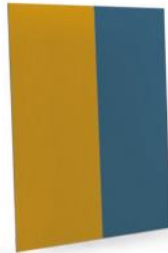

Colorful Blank Wall



Single Color Blank Wall



It is very easy to change the container plan with standardized dimensions in the short and long directions. Whether on the first installation, in the installed container, or on re-installation after packaging. At any time you want You can change the plan of the container you want according to your needs. Moreover, deformed walls or in the changes you will make for new needs, you can only meet your needs by buying a new wall. Contact us for your special wall requests

LOGISTICS

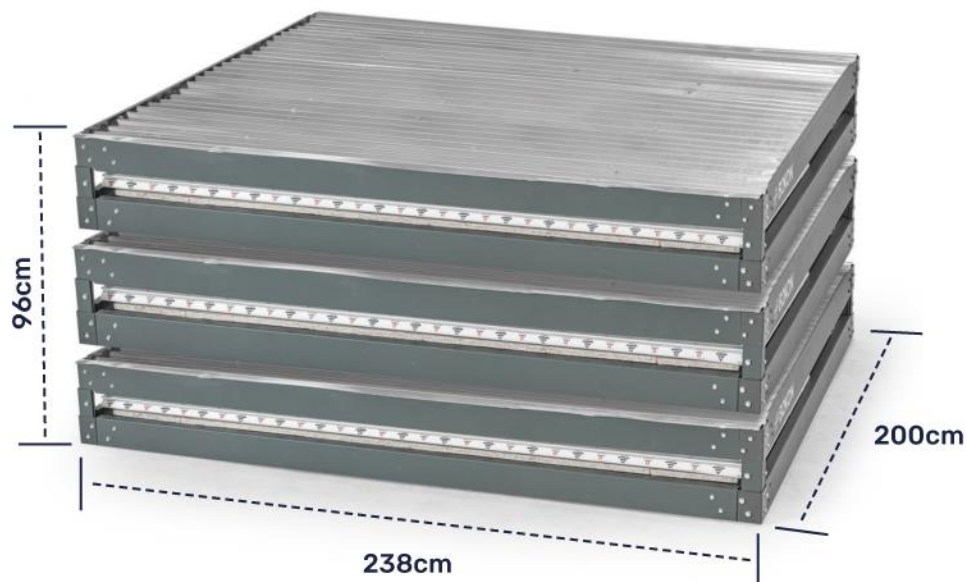

WORLD'S SMALLEST PACKED 2,4m x 6m x 2,5m CONTAINER

"Logistics and stacking issues are of great importance for containers. Unimod Container, which was designed by taking into account its exponentially shrinking dimensions and the capacities of standard transportation vehicles, stands out with its ability to transport many pieces at once. Unimod, which offers both easy assembly and disassembly with bolts and special hiding parts. It keeps the quality of the container at the highest level with its sealing and durability. It can be easily installed without a crane with 4 people in places where cranes cannot enter, and Unimod Container provides ease of installation in the most difficult conditions.



X16

X13



16 Trimod can be transported with an 90m³ truck.

With 60m³ High Cube container
13Trimods can be carried.

It helps you to reduce your logistics costs and CO2 emissions.

ASSEMBLY DISASSEMBLY



Please scan the code for the assembly video.



Please scan the code for the disassembly video.



STEP 1

The package is brought to the area where the product will be installed. The floor must be level.



STEP 6



Other modules are placed next to the installed module, the bolt holes are matched to each other and the bolts are tightened.



STEP 2

The upper module corner points are removed from the package by removing the bolts.



STEP 7

The wall is placed in the desired combination. It is fixed with top slats.



STEP 3

The package is emptied out so that only the submodule remains.



STEP 8

The electrical box is fixed to the wall. The cable is hidden inside the duct and the electrical wiring is connected to each other from the upper module corners of the wall.



STEP 4

The struts are fixed to the lower module with bolts.



STEP 9

Module joints, skirting boards and square profiles are screwed to the wall.



STEP 5

The upper module is placed on the uprights. The bolts are fixed by tightening.



STEP 10

Window and door wings are mounted on their frames. The container is complete.







DUOMOD

Double Module Container

238cm x 400cm x 250cm

- Ready Electrical Installation
- Modern appearance.
- Safe and productive environment.
- Warehouse, waiting room, sales office, construction site, home, office, box office, laboratory, test center, health cabinet custom measure for fields."
- Possibility to convert to Unimod and Trimod later.

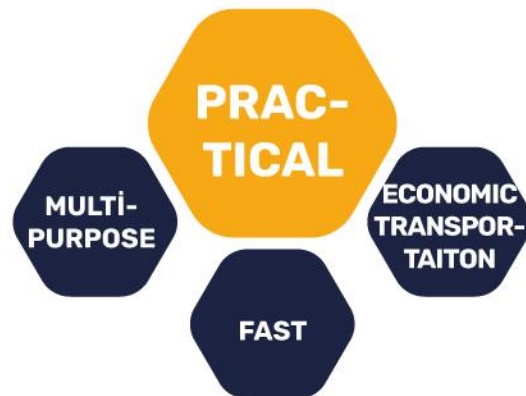

WIDE



WIDE *duomod*

It contains two windows and a door in the long direction. It is one step ahead with its ability to respond to all space needs and design flexibility.

BOX



BOX *duomod*

It contains a window and a door in the short direction. Your assistant in creating productive areas with its superior insulation properties.

LUMI



LUMI *duomod*

It contains two spacious walls in the long direction, and a door and window in the short direction. It has been designed to perfectly meet your need to use light effectively and display the inside of the container.



WIDE



BOX



LUMI



High Insulation
Full Waterproof



High Security



Ready Electrical System All
in One Point Full
Protection



LED Technology
Recessed Luminaire



Easy Installation
Lightweight and Robust



Aesthetic Combinations
Useful Areas



CAPACITY	RUST PROTECTION	PAINT	SNOW LOAD
*200kg/m²	DKP Sheet	Filler+Top Coat Paint	80kg/m²
300kg/m²	*Zinc Coated Sheet (Galvanised)	-	*100/m²
400kg/m²	-	Powder Coating	-



ELECTRICITY	INSULATION	CEILING COATING MATERIAL
Without Electrical Installation	*Mineral Wool	*PVC Wainscot
*Leakage Current Protection Installation	-	Wood Paneling



COATING MATERIAL	INSULATION	PATTERN
*PVC Floor	*Felt	* Hardwood Look
SPC Flooring	Additional Foam Insulation	Mercenary View
Aluminum Floor Coating	-	Industrial Look



INSULATION	THICKNESS	PATTERN
EPS* Expanded Polystyrene	4*	*Deep Trace
PUR Polyurethane	5	Micro Pattern
PIR Polyisocyanurate	8	Sine Wave
Rock wool	10	Siding Pattern

* The specified features are those found in the standard product. You must specify other options before ordering.

WALL MODULES



Wall with Door



Lumi Wall



Wall with Single Opening Window



Double Window Wall



Blank Wall

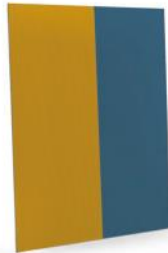

Colorful Blank Wall



Single Color Blank Wall



It is very easy to change the container plan with standardized dimensions in the short and long directions. Whether on the first installation, in the installed container, or on re-installation after packaging. At any time you want You can change the plan of the container you want according to your needs. Moreover, deformed walls or in the changes you will make for new needs, you can only meet your needs by buying a new wall. Contact us for your special wall requests

LOGISTICS

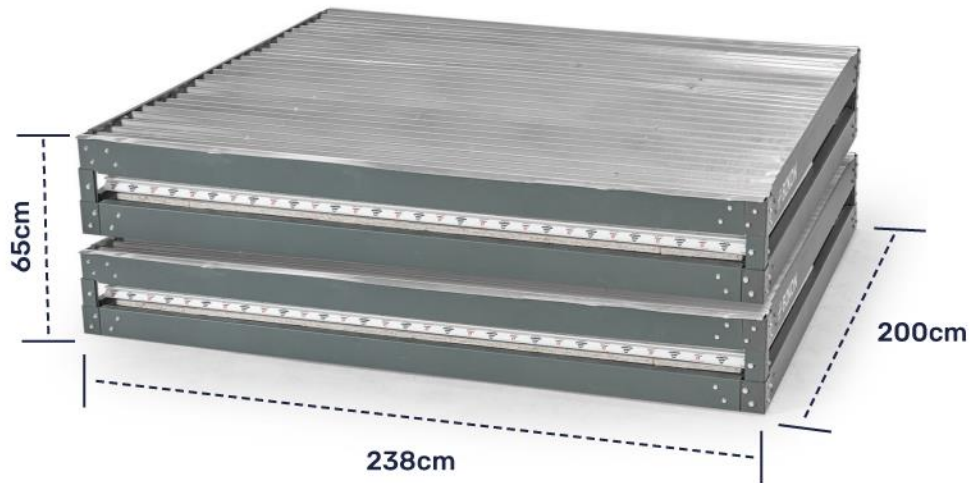

COMPACT PACKAGE COMPACT SIZE

Logistics and stacking issues are of great importance for containers. Trimod Container, which was designed by taking into account its exponentially shrinking dimensions and the capacities of standard transportation vehicles, stands out with its ability to transport many pieces at once. Trimod, which offers both easy assembly and disassembly with bolts and special hiding parts. It keeps the quality of the container at the highest level with its sealing and durability. It can be easily installed without a crane with 4 people in places where cranes cannot enter, and Trimod Container provides ease of installation in the most difficult conditions.



X21

21 Duomods can be transported with an 90m³ truck.



X17

With 60m³ High Cube container
17 Duomods can be carried.

It helps you to reduce your logistics costs and CO2 emissions.

ASSEMBLY DISASSEMBLY



Please scan the code for the assembly video.



Please scan the code for the disassembly video.



STEP 1

The package is brought to the area where the product will be installed. The floor must be level.



STEP 6

Other modules are placed next to the installed module, the bolt holes are matched to each other and the bolts are tightened.



STEP 2

The upper module corner points are removed from the package by removing the bolts.



STEP 7

The wall is placed in the desired combination. It is fixed with top slats.



STEP 3

The package is emptied out so that only the submodule remains.



STEP 8

The electrical box is fixed to the wall. The cable is hidden inside the duct and the electrical wiring is connected to each other from the upper module corners of the wall.



STEP 4

The struts are fixed to the lower module with bolts.



STEP 9

Module joints, skirting boards and square profiles are screwed to the wall.



STEP 5

The upper module is placed on the uprights. The bolts are fixed by tightening.



STEP 10

Window and door wings are mounted on their frames. The container is complete.







UNIMOD

Single Container

238cm x 200cm x 250cm

- Unlimited combinations with ready-made panel walls.
- Sealed walls, heat and windproof insulated roof.
- Wc, shower, warehouse, ticket office, sales station, security cabin, smoking room etc. suitable solutions for your need
- Possibility to convert to Duomod and Trimod later.



BOX



BOX unimod

One door in the short direction includes.
Efficient with superior insulation
properties
Helps to create fields

LUMI



LUMI unimod

Two Lumi windows in the short direction,
one door in the long direction
and includes a window module. Designed
for using light effectively and for display
container inside



BOX



WIDE



High Insulation
Full Waterproof



High Security



Ready Electrical System All
in One Point Full
Protection



LED Technology
Recessed Luminaire



Easy Installation
Lightweight and Robust



Aesthetic Combinations
Useful Areas

CHASSIS



CAPACITY	RUST PROTECTION	PAINT	SNOW LOAD
*200kg/m ²	DKP Sheet	Filler+Top Coat Paint	80kg/m ²
300kg/m ²	*Zinc Coated Sheet (Galvanised)	-	*100/m ²
400kg/m ²	-	Powder Coating	-

UPPER MODULE

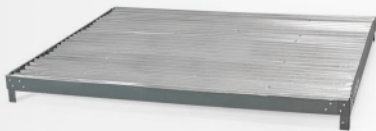

ELECTRICITY	INSULATION	CEILING COATING MATERIAL
Without Electrical Installation	*Mineral Wool	*PVC Wainscot
*Leakage Current Protection Installation	-	Wood Paneling

SUB MODULE



COATING MATERIAL	INSULATION	PATTERN
*PVC Floor	*Felt	* Hardwood Look
SPC Flooring	Additional Foam Insulation	Mercenary View
Aluminum Floor Coating	-	Industrial Look

WALLS



INSULATION	THICKNESS	PATTERN
EPS* Expanded Polystyrene	4*	*Deep Trace
PUR Polyurethane	5	Micro Pattern
PIR Polyisocyanurate	8	Sine Wave
Rock wool	10	Siding Pattern

* The specified features are those found in the standard product. You must specify other options before ordering.

WALL MODULES



Wall with Door



Lumi Wall



Wall with Single
Opening Window



Double Window Wall



Blank Wall

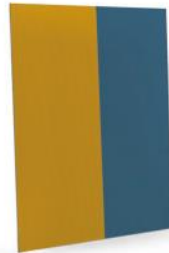

Colorful Blank Wall



Single Color Blank Wall



It is very easy to change the container plan with standardized dimensions in the short and long directions. Whether on the first installation, in the installed container, or on re-installation after packaging. At any time you want You can change the plan of the container you want according to your needs. Moreover, deformed walls or in the changes you will make for new needs, you can only meet your needs by buying a new wall. Contact us for your special wall requests

LOGISTICS

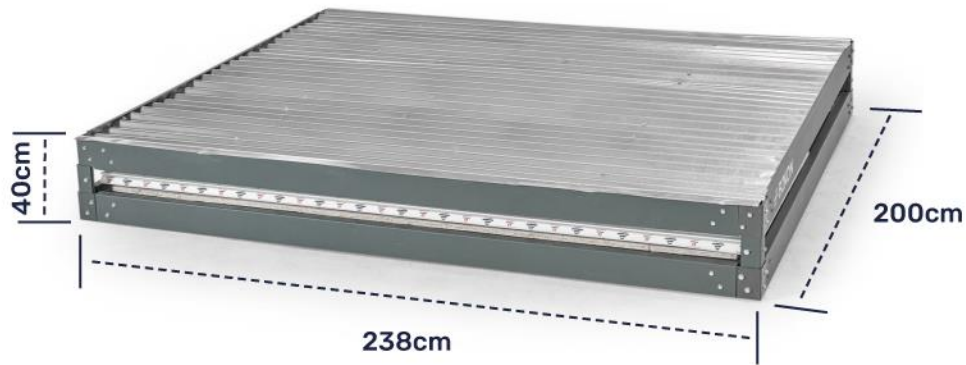

Logistics and stacking issues are of great importance for containers. Unimod Container, which was designed by taking into account its exponentially shrinking dimensions and the capacities of standard transportation vehicles, stands out with its ability to transport many pieces at once. Unimod, which offers both easy assembly and disassembly with bolts and special hiding parts. It keeps the quality of the container at the highest level with its sealing and durability. It can be easily installed without a crane with 4 people in places where cranes cannot enter, and Unimod Container provides ease of installation in the most difficult conditions.



X34

34 Unimods can be transported with an 90m³ truck.



X28

With 60m³ High Cube container
28 Trimods can be carried.

It helps you to reduce your logistics costs and CO2 emissions.

ASSEMBLY DISASSEMBLY



Please scan the code for the assembly video.



Please scan the code for the disassembly video.



STEP 1

The package is brought to the area where the product will be installed. The floor must be level.



STEP 6



Other modules are placed next to the installed module, the bolt holes are matched to each other and the bolts are tightened.



STEP 2

The upper module corner points are removed from the package by removing the bolts.



STEP 7

The wall is placed in the desired combination. It is fixed with top slats.



STEP 3

The package is emptied out so that only the submodule remains.



STEP 8

The electrical box is fixed to the wall. The cable is hidden inside the duct and the electrical wiring is connected to each other from the upper module corners of the wall.



STEP 4

The struts are fixed to the lower module with bolts.



STEP 9

Module joints, skirting boards and square profiles are screwed to the wall.



STEP 5

The upper module is placed on the uprights. The bolts are fixed by tightening.



STEP 10

Window and door wings are mounted on their frames. The container is complete.







SOLID LINKABLE

Single Floor Facilities

238cm x 600cm x 250cm

- Leakproof walls, heat and windproof insulated roof.
- Possibility of creating a continuous opening of 600 m width
- It joins from the short and long edges. Offers solutions to facility needs with changes on interior walls, glass, doors, etc.
- Possibility of establishing facilities for infirmary, field hospital, sports social facilities, construction site office kitchen, laundry etc. needs.



WIDE



BOX

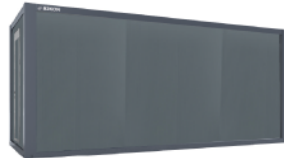
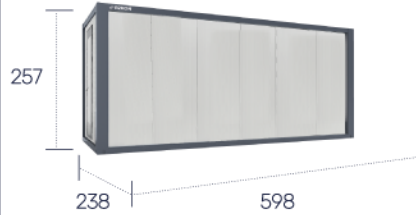

LUMI

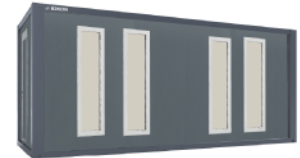

WIDE *Solid*

It is the container with two windows and one door in the long direction. It is one step ahead with its ability to respond to all space needs and design flexibility.

BOX *Solid*

It is the container that contains a window and a door in the short direction. Your assistant in creating productive areas with its superior insulation properties.

LUMI *Solid*

It contains three spacious walls in the long direction and a door and window in the short direction. Using light effectively and inside the container It allows you to showcase.



WIDE



BOX



LUMI



Superior Insulation / Leakproof



High Security



Aesthetic Finishes



Suitable for single floor facilities, Linkable

CHASSIS



CAPACITY	RUST PROTECTION	PAINT	SNOW LOAD
*200kg/m ²	Hollow Section	Filler+ Topcoat Paint	80kg/m ²
300kg/m ²	Galvanised Hollow Section	-	*100/m ²
400kg/m ²	-	Powder Coating	

UPPER MODULE



ELECTRICITY	INSULATION	CEILING COATING MATERIAL
Without Electrical Installation	*EPS, PIR, PUR Mineral Wool	Sandwich Panel
*Leakage Current Protection Installation	-	-

SUB MODULE



COATING MATERIAL	INSULATION	PATTERN
*PVC Floor	*Felt	* Hardwood Look
SPC Floor	Additional Foam Insulation	Mercenary View
Aluminum Floor Coating	-	Industrial Look

WALLS



INSULATION	THICKNESS	PATTERN
EPS* Expanded Polystyrene	4*	*Deep Trace
PUR Polyurethane	5	Micro Pattern
PIR Polyisocyanurate	8	Sine Wave
Rock wool	10	Siding Pattern

* The specified features are those found in the standard product. You must specify other options before ordering.

WALL MODULES



Wall with Door



Lumi Wall



Wall with Single
Opening Window



Double Window Wall



Blank Wall

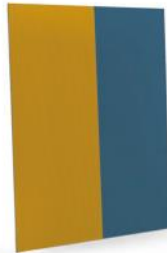

Colorful Blank Wall



Single Color Blank Wall



It is very easy to change the container plan with standardized dimensions in the short and long directions. Whether on the first installation, in the installed container, or on re-installation after packaging. At any time you want You can change the plan of the container you want according to your needs. Moreover, deformed walls or in the changes you will make for new needs, you can only meet your needs by buying a new wall. Contact us for your special wall requests

LOGISTICS

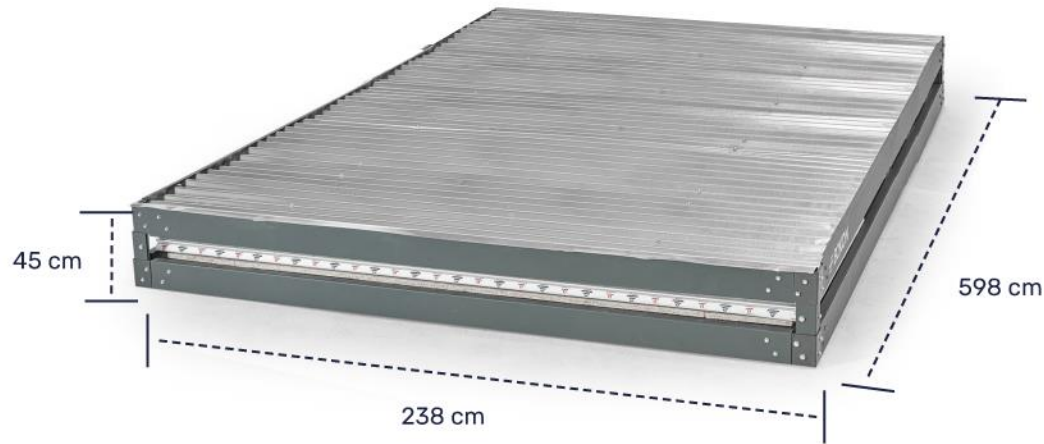

COMPACT PACKAGE COMPACT SIZE

"Logistics and stacking issues are of great importance for containers. Solid Linkable Container, which was designed by taking into account its exponentially shrinking dimensions and the capacities of standard transportation vehicles, stands out with its ability to transport many pieces at once. Solid Linkable offers both easy assembly and disassembly with bolts and special hiding parts. It keeps the quality of the container at the highest level with its sealing and durability. It can be easily installed without a crane with 4 people in places where cranes cannot enter, and Solid Linkable provides ease of installation in the most difficult conditions.



X10



X8

Up to 10 Solid Linkable can be transported with an 90m³ truck.

It helps you to reduce your logistics costs and CO2 emissions.

With 60m³ High Cube container
8 Solid Linkable can be carried.

ASSEMBLY DISASSEMBLY



Please scan the code for the assembly video.



Please scan the code for the disassembly video.



STEP 1

The package is brought to the area where the product will be installed. The floor must be level.



STEP 6



Other modules are placed next to the installed module, the bolt holes are matched to each other and the bolts are tightened.



STEP 2

The upper module corner points are removed from the package by removing the bolts.



STEP 7

The wall is placed in the desired combination. It is fixed with top slats.



STEP 3

The package is emptied out so that only the submodule remains.



STEP 8

The electrical box is fixed to the wall. The cable is hidden inside the duct and the electrical wiring is connected to each other from the upper module corners of the wall.



STEP 4

The struts are fixed to the lower module with bolts.



STEP 9

Module joints, skirting boards and square profiles are screwed to the wall.



STEP 5

The upper module is placed on the uprights. The bolts are fixed by tightening.



STEP 10

Window and door wings are mounted on their frames. The container is complete.



ALL WAYS





SOLID STACKABLE

Double Floor Facilities

238cm x 600cm x 250cm

- Leakproof walls, heat and windproof insulated roof.
- Possibility of creating a continuous opening of 600 m width and second floor
- It joins from the short and long edges. Offers solutions to facility needs with changes on interior walls, glass, doors, etc.
- Possibility of establishing facilities for infirmary, field hospital, sports social facilities, construction site office kitchen, laundry etc. needs.



WIDE



BOX



LUMI

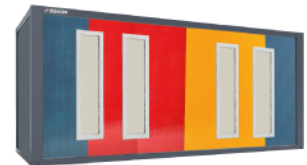
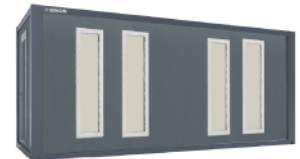
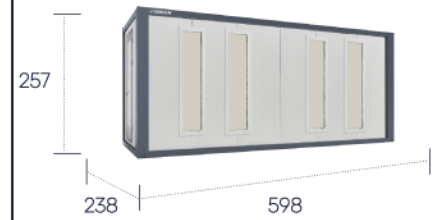

WIDE *Solid*

It is the container with two windows and one door in the long direction. It is one step ahead with its ability to respond to all space needs and design flexibility.

BOX *Solid*

It is the container that contains a window and a door in the short direction. Your assistant in creating productive areas with its superior insulation properties.

LUMI *Solid*

It contains three spacious walls in the long direction and a door and window in the short direction. Using light effectively and inside the container it allows you to showcase.



WIDE



BOX



LUMI



Superior Insulation / Leakproof



High Security



Aesthetic Finishes



Suitable for double floor facilities, Linkable

CHASSIS



CAPACITY	RUST PROTECTION	PAINT	SNOW LOAD
*200kg/m ²	Hollow Section	Filler+ Topcoat Paint	80kg/
300kg/m ²	Galvanised Hollow Section	-	*100/
400kg/m ²	-	Powder Coating	

UPPER MODULE



ELECTRICITY	INSULATION	CEILING COATING MATERIAL
Without Electrical Installation	*EPS, PIR, PUR Mineral Wool	Sandwich Panel
*Leakage Current Protection Installation	-	-

SUB MODULE



COATING MATERIAL	INSULATION	PATTERN
*PVC Floor	*Felt	* Hardwood Look
SPC Floor	Additional Foam Insulation	Mercenary View
Aluminum Floor Coating	-	Industrial Look

WALLS



INSULATION	THICKNESS	PATTERN
EPS* Expanded Polystyrene	4*	*Deep Trace
PUR Polyurethane	5	Micro Pattern
PIR Polyisocyanurate	8	Sine Wave
Rock wool	10	Siding Pattern

* The specified features are those found in the standard product. You must specify other options before ordering.

LOGISTICS

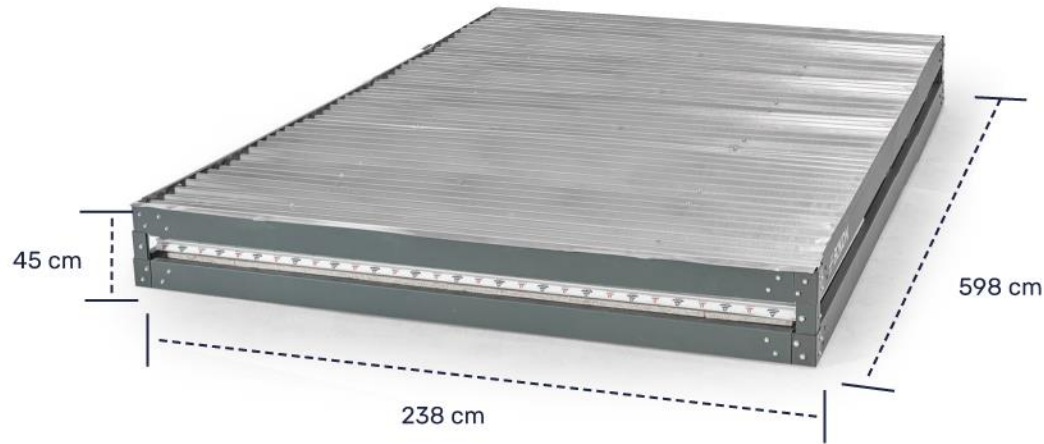

COMPACT PACKAGE COMPACT SIZE

"Logistics and stacking issues are of great importance for containers. Solid Linkable Container, which was designed by taking into account its exponentially shrinking dimensions and the capacities of standard transportation vehicles, stands out with its ability to transport many pieces at once. Solid Linkable offers both easy assembly and disassembly with bolts and special hiding parts. It keeps the quality of the container at the highest level with its sealing and durability. It can be easily installed without a crane with 4 people in places where cranes cannot enter, and Solid Linkable provides ease of installation in the most difficult conditions.



X10



X8

Up to 10 Solid Linkable can be transported with an 90m³ truck.

It helps you to reduce your logistics costs and CO2 emissions.

With 60m³ High Cube container
8 Solid Linkable can be carried.

ASSEMBLY DISASSEMBLY



Please scan the code for the assembly video.



Please scan the code for the disassembly video.



STEP 1

The package is brought to the area where the product will be installed. The floor must be level.



STEP 6



Other modules are placed next to the installed module, the bolt holes are matched to each other and the bolts are tightened.



STEP 2

The upper module corner points are removed from the package by removing the bolts.



STEP 7

The wall is placed in the desired combination. It is fixed with top slats.



STEP 3

The package is emptied out so that only the submodule remains.



STEP 8

The electrical box is fixed to the wall. The cable is hidden inside the duct and the electrical wiring is connected to each other from the upper module corners of the wall.



STEP 4

The struts are fixed to the lower module with bolts.



STEP 9

Module joints, skirting boards and square profiles are screwed to the wall.



STEP 5

The upper module is placed on the uprights. The bolts are fixed by tightening.



STEP 10

Window and door wings are mounted on their frames. The container is complete.





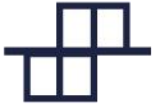

COMBINATION FACILITY

- Design Your Facility with Unit Container
- Unlimited Combinations
- Facility from Unit Modules
- Unit containers can be connected to each other in the desired direction. Based on our unit module dimensions, you can give your facility the shape you want.
- B2KON Containers, with their design that can be easily added to each other, offer the opportunity to enlarge or reduce your facility at any time.



EXAMPLE FACILITES

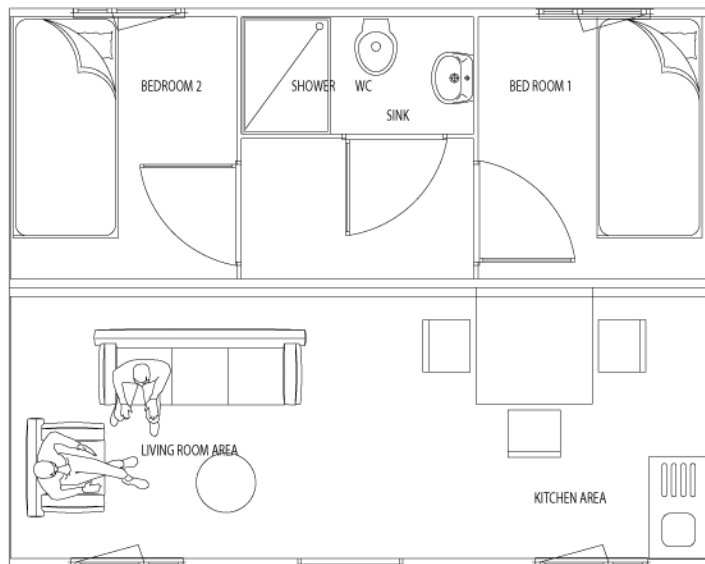

2 SOLID
Accommodation Solution
2 people

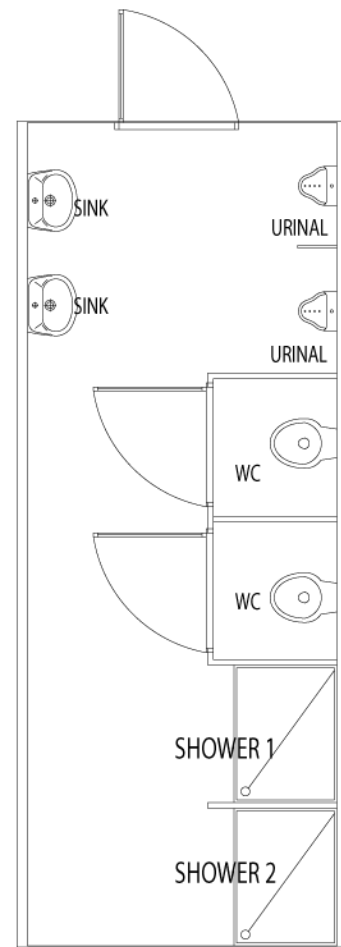

1 SOLID
Field WC/ Shower Solution

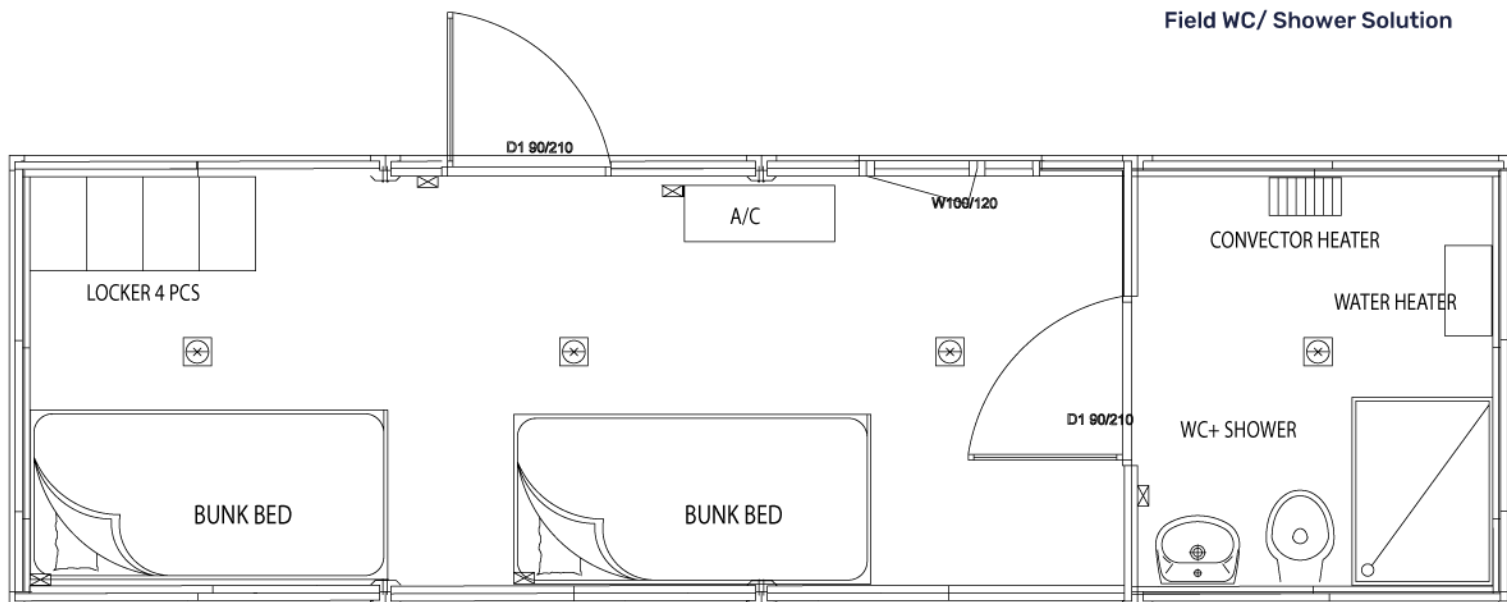

TRIMOD + UNIMOD

Accommodation Solution

Extra Insulated

Heating & Cooling

4 People

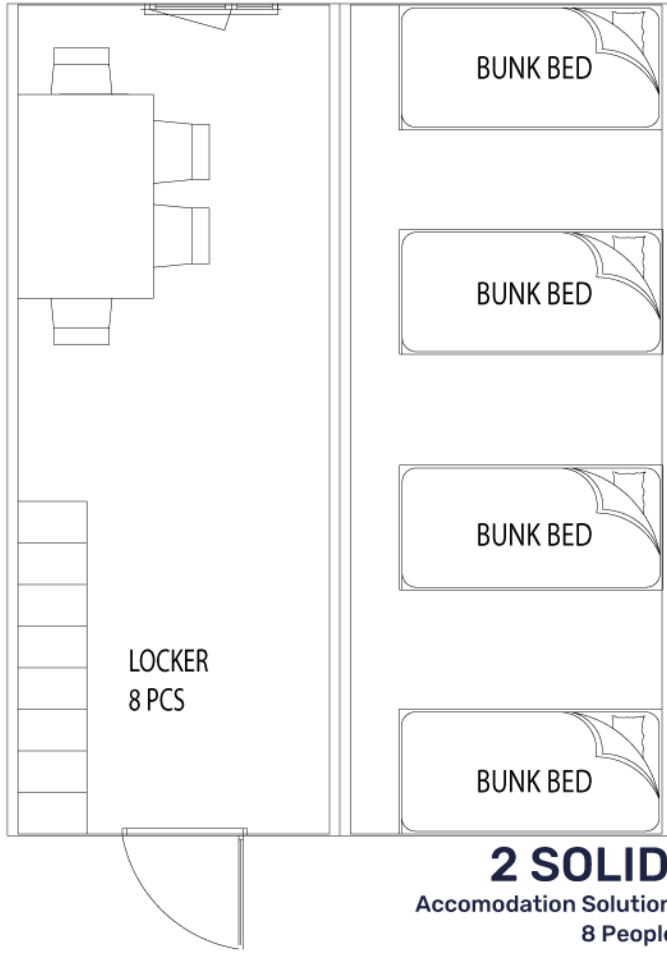

8 SOLID
Kitchen
100 people
Prepare
Serve

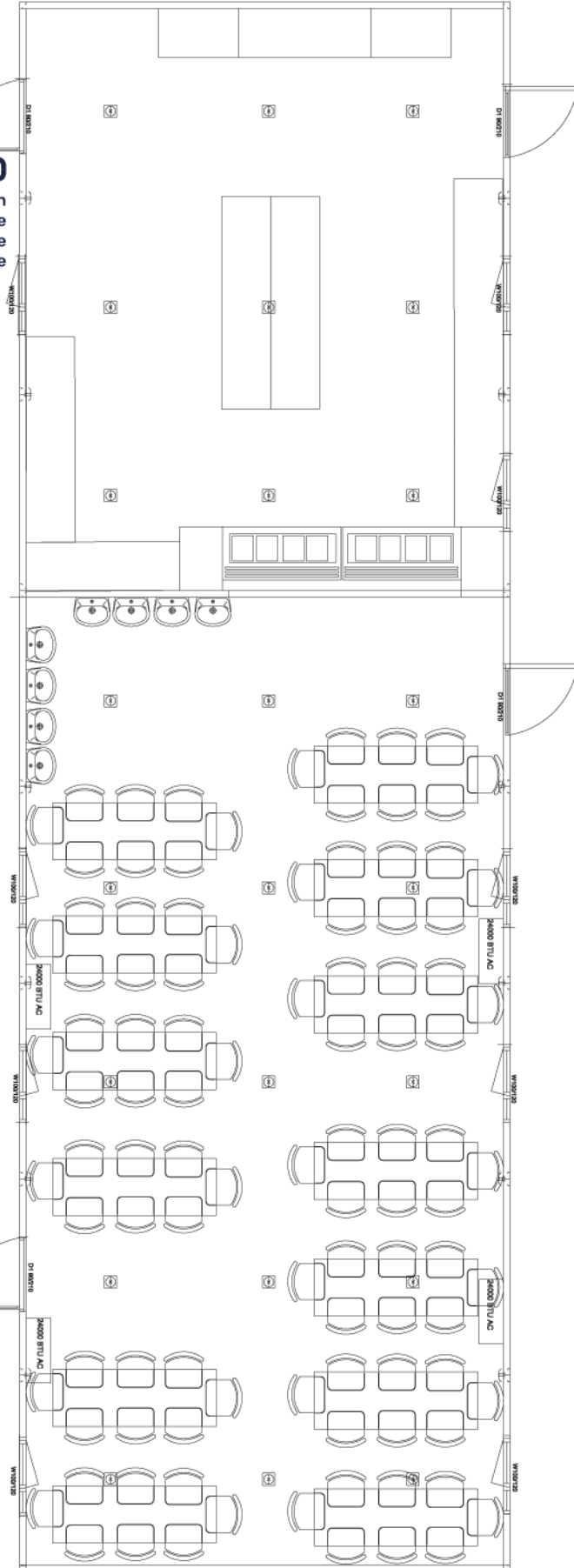

10 SOLID +5 UNIMOD
Saha Yönetim Tesisi

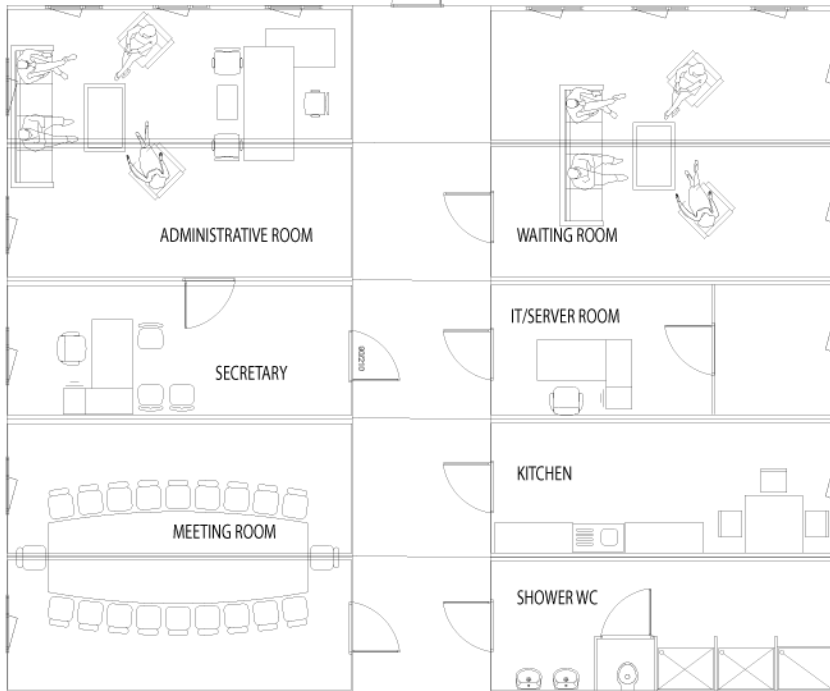

ACCESSORIES

Optional



Kitchen Cabinet + Sink



Shower Tray + Cabin



WC + Sink+ Foot.



Fixed&Accordion
Fly Screens

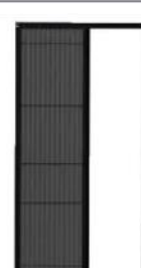

Convactor Heater



Air Conditioning



Ready to Use
Bunk Bed



Lockable
Metal Locker



Aluminum
Blinds

TECNICAL SPECIFICATIONS

WC + Sink+ Foot.	35-45 Sink, Wall Drain WC, Ceramic Material, PPRC Plumbing
Shower Tray + Cabin	75x100 cm Fiber Shower Tray + Mica Shower Cabin with Aluminum Slats
Kitchen Cabinet + Sink	50x100x88 cm (WxLxH) Base Cabinet, Metal Sink
Convactor Heater	2500 Watt, Adjustable Power Control, Whether for Wall Mounting or Floor Use
Air Conditioning	12000 BTU Heating and Cooling, A++, 55 dB
Ready to Use Bunk Bed	90x190 cm, Powder coating, 2x Spring Mattress, 2 Pillows and 2 Duvets
Lockable Metal Locker	180x30cm, Metal, 2 Covers, Lockable
Aluminum Blinds	100x120 cm, Aluminum Material, PUR Thermal Insulation Filled, RAL 7016 Anthracite



TECHNICAL INFORMATION

1 - General Information

B2KON containers consist of 4 main components: lower module, walls, upper module and chassis. Standard changes that can be made in the product are made through the components. In this section, the components detailed technical data.

2 - Dimensions

PRODUCT	LENGTH	WIDTH	HEIGHT	WEIGHT
UNIMOD	200cm	238cm	250cm	400kg
DUOMOD	400cm	238cm	250cm	750kg
TRIMOD	600cm	238cm	250cm	1100kg
SOLIDS	600cm	238cm	250cm	1100kg

Dimensions are outside to outside measurements. Inside dimensions are wall thickness, window type, etc. varies according to preferences.

3- Load Bearing Capacity

LOAD BEARING CAPACITY							
According to Point Supporting Bearing Capacity of supporting from bottom of studs				According to Continuous Supporting Bearing Capacity of supporting along whole bottom modules.			
Bottom Chassis Bearing Capacity	Type	Load	Unit	Type	Load	Unit	Usage Area
	Carcass Type-1	200	kg/m ²	Carcass Type-1	250	kg/m ²	residence, office, shop
	Carcass Type-2	300	kg/m ²	Carcass Type-2	350	kg/m ²	School, dormitory, dining hall
	Carcass Type-3	500	kg/m ²	Carcass Type-3	600	kg/m ²	Garage (up to 2.5 tons), warehouse
Snow Load Bearing Capacity	Type	Load	Unit	Type	Load	Unit	Usage Area
	Carcass Type-1	80	kg/m ²	Carcass Type-1	80	kg/m ²	residence, office, shop
	Carcass Type-2	100	kg/m ²	Carcass Type-2	100	kg/m ²	School, dormitory, dining hall
	Carcass Type-3	120	kg/m ²	Carcass Type-3	120	kg/m ²	Garage (up to 2.5 tons), warehouse
Wind Load Bearing Capacity	Type	Load	Unit	Type	Load	Unit	Usage Area
	Carcass Type-1	90	km/hour	Carcass Type-1	90	km/hour	residence, office, shop
	Carcass Type-2	90	km/hour	Carcass Type-2	90	km/hour	School, dormitory, dining hall
	Carcass Type-3	90	km/hour	Carcass Type-3	90	km/hour	Garage (up to 2.5 tons), warehouse

Load bearing capacities and loads are based on European Standards (Eurocode 3 for steel structures, Eurocode 1 for loads). The ground on which the container will be installed must be absolutely level. Do not go above the upper module of the container. Water tanks, air conditioners, antennas and similar products should not be placed directly on the roof sheet. Wind resistance is provided that the container is fixed to the ground. National regulations and other special load conditions (earthquake, vibration and similar) are applied specifically to the project. Also, contact us for your special requests.

4 - Dry Walls

In the standard product, the ceiling covering is made with PVC panels. Wooden paneling is also used on order. Zinc-plated (galvanized) sinus or trapezoidal corrugated metal roofing sheet is used for the roof covering of all modules. Oriented wood fiber boards (OSB) with a thickness of 18 mm are used for floor coverings. For the carrying capacities specified as Type-2 and Type-3 in the load bearing table, 18 mm thick plywood (Plywood) is used instead of wood fiber board. 2 mm thick PVC floor (mineflo) with felt bottom is used as standard surface coating. Different from the standard, linoleum and patterned aluminum are also offered as options when ordering.

TECHNICAL INFORMATION

5 - Rust Protection and Paints

Zinc-plated (galvanized) sheets are used on the chassis of the standard product. The average amount of zinc on the sheet surface is 500 gr/m². The material meets TS EN 10346 quality standards. In addition, DKP sheet paint chassis production is also made upon request.

Semi-matt texture electrostatic powder paint in RAL 7016 color is applied as standard on the chassis. For the desired product in different colors, you must inform the RAL color code in advance. In addition, rapid, acrylic and epoxy based paint preferences are offered to the buyer.

The standard color for sandwich panel walls is RAL 9002. This color is applied both on the inner surface and on the outer surface. The walls are painted with the roller painting technique during the sandwich panel production. Colors other than RAL 9002 are painted in the workshop with high-resistance acrylic-based paints specially produced for sandwich panel painting. For the desired product in different colors, you must inform the RAL color code in advance.

6 - Thermal Insulation

INSULATION MATERIAL	MATERIAL THICKNESS (mm)	THERMAL CONSUMPTION COEFFICIENT (W/m ² K)
THERMAL CONSUMPTION COEFFICIENT		
Mineral Wool Based	50	0,74
Glass Wool Based	100	0,36
SANDWICH PANEL WALL		
EPS	40	0,92
EPS	50	0,73
Polyurethane	40	0,67
Polyurethane	50	0,50
Polyisocyanurate	40	0,67
Polyisocyanurate	50	0,50
Rock wool	50	0,77
Rock wool	80	0,45
PVC WINDOW		
Standard Double Glazed	4mm glass 12mm gap	1,10
DOOR		
Same as Wall Sandwich Panel		

7 - Rust Protection and Paints

Three different windows are used in our standard production. The first one is a 98x120 cm single wing window, the second one is a 140x120 cm double winged window and the third one is a 50x180 cm single wing window. The windows are white PVC cased. The glasses are double glazed with 4mm glass and 12mm gap.

Container doors are steel framed doors. The door leaf is in the same insulation material and pattern as the selected sandwich wall. Door size is 90x210 cm. Standard doors are semi-matt electrostatic powder painted in RAL 7016 color. Chassis orders in different colors come in the same color as the chassis. Security is provided by cylinder locks.

All doors and windows are shipped mounted on sandwich walls. What the user has to do is attach the wings and arms of the assembled wall that comes out of the package.



TECHNICAL INFORMATION

8- Electrical Installation

	DEFAULT	SPECIAL
Voltage	220V	110V
Frequency	50Hz	60Hz
Protection	25A – 30mA Residual Current Protection Relay	25A Automatic Fuse Added
Cable	1.5mm ² H05VV-F maximum current carrying capacity 20A (TTR Harmonized Flexible PVC Cable)	2.5mm ² NHXMH maximum current carrying capacity 32A (Halogen Free Sheathed Wire with Improved Fire Behavior)
Energy Input	Rubber Socket IP44 Protection Class 220V	
Modular Socket Box	Modular type plug-in socket cases, DIN rail case for MCB/RCD, socket plates; nylon-6 (PA6), MCB/RCD case's transparent cover is polycarbonate (PC), front cover and S/Ü mounting box are made of ABS material, halogen-free and flame- retardant.	add-on module
Socket Box – Connector	Industrial metal body, 5 contacts 10A current carrying capacity plug and socket, IP65 protection class with the addition of PG11 cable gland	-
Socket	45x55mm grounded socket (maximum current carrying cap. 16A) in wall mounted modular socket box	number of additional sockets
Switch	45x55mm grounded socket in wall mounted modular socket box (maximum current carrying cap. 10A)	-
Cable canal	16mmx16mm Adhesive plastic cable tray	-
Lighting Fixture	LED, Recessed, 23 Watt, 1020 Lumens, 6,000K, 30,000 hours life	Surface Mounted, 18W, 4,000K, 3,000K light color options
Energy Efficiency Class	A++	-
Grounding	The installation itself is grounded. If the main input supply cable is grounded, the installation will be grounded. If grounding of the container chassis is desired, the chassis is grounded if 2.5mm ² copper is connected to any of the gaps at the junction points and Ø 20mm ² copper conductor driven into the ground.	-

- Connect the metal-bodied female plug at the end of the socket module box cable to the metal-bodied female plug at the end of the cable suspended in the container.
- Fix the socket module box to the wall.
- Make the energy input by plugging your plug into the rubber socket hidden in the roof.
- Make sure that the residual current relays/automatic fuses inside the container are closed.
- After checking the connections, turn on the switch. Your electrical installation is ready for use.
- All parts of the electrical installation must be kept away from water.D435

LOGISTICS

PRODUCT	DIMENSIONS				
UNIMOD		34	28	400	200 x 238 x 40
DUOMOD		21	17	750	200 x 238 x 65
TRIMOD		18	13	1100	200 x 238 x 95
SOLIDS		10	8	*+1250/1800	598x 238 x 45

This table;
The box was created by considering the standard equipment and box design.
There may be + - 2 cm differences in the measurements.
There may be differences in weights by + - 20 kg.

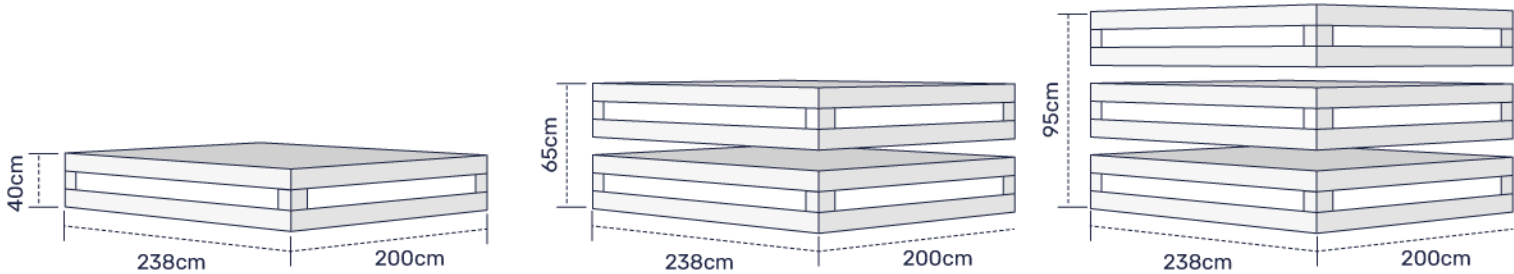



PHOTO GALLERY





